

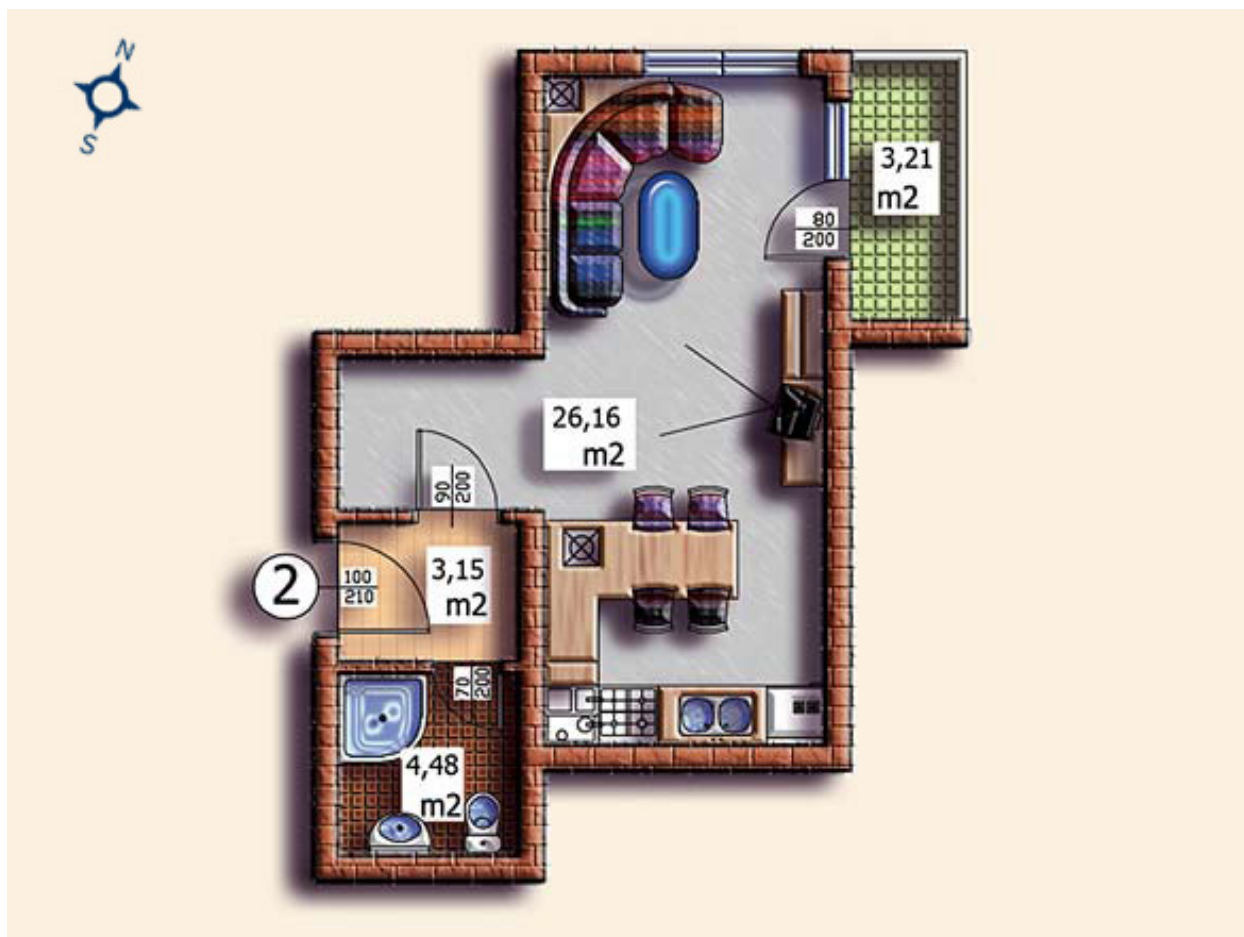

## Lorena 2/ Appartement B1

### Studio

Entrée :	3.15 sq.m.
Terrasse :	3.21 sq.m.
Salon + cuisine :	26.16 sq.m.
Salle de bain (1) :	4.48 sq.m.
Entrée :	3.15 sq.m.
Parties communes :	4.78 sq.m.
Surface totale :	37 sq.m.
Totale + Parties communes :	41.78 sq.m.
<b>Prix* :</b>	<b>46 959.00 EUR</b>
	<i>* Vat inclure</i>





# Crystal Spa Aparthotel

partie de golden valley village

