

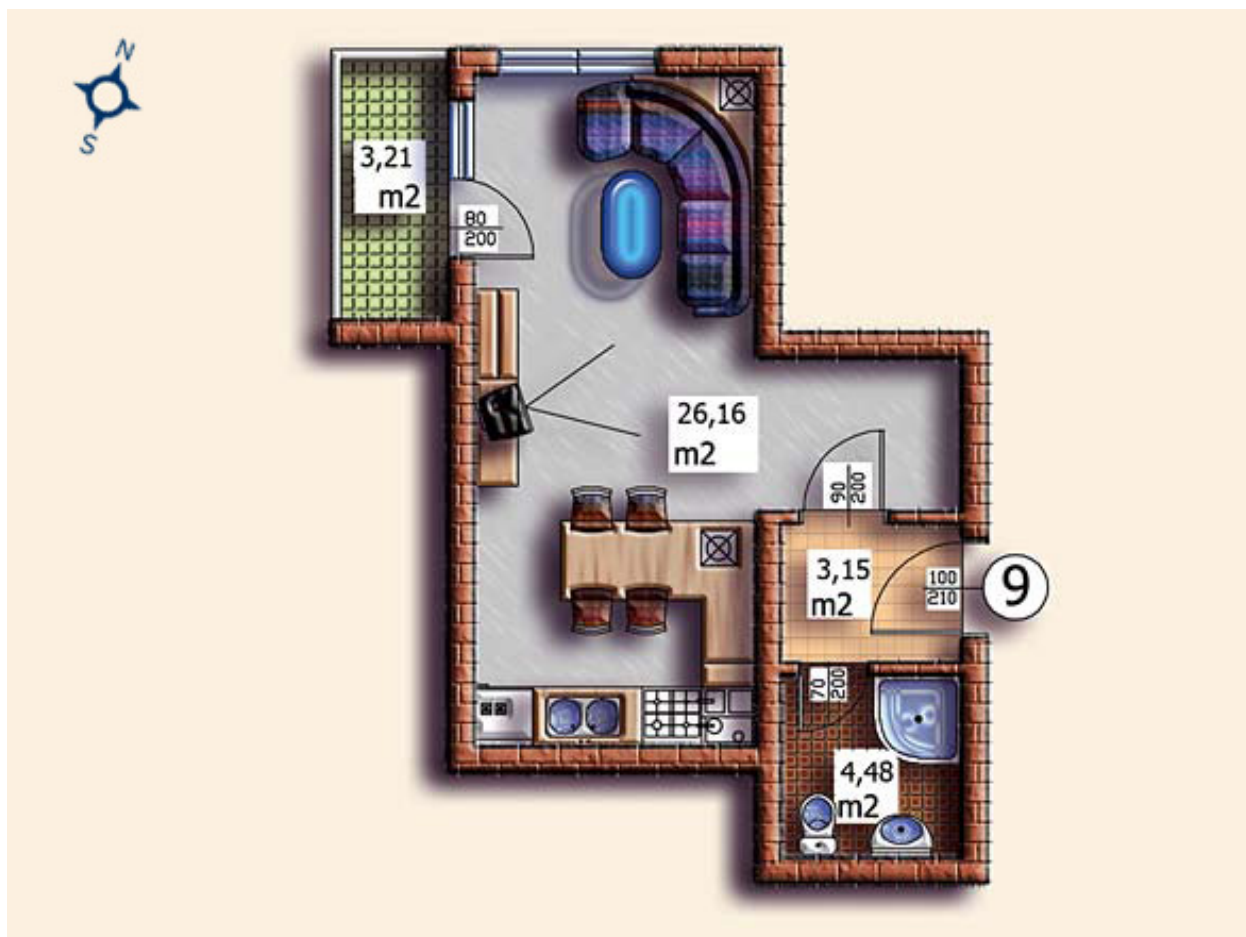

Lorena 2/ Appartement I1

Studio

Entrée : 3.15 sq.m.
Terrasse : 3.21 sq.m.
Salon + cuisine : 26.16 sq.m.
Salle de bain (1) : 4.48 sq.m.
Entrée : 3.15 sq.m.
Parties communes : 4.78 sq.m.
Surface totale : 37 sq.m.
Totale + Parties communes : 41.78 sq.m.
Prix* : 46 959.00 EUR
** Vat inclure*





Crystal Spa Aparthotel

partie de golden valley village

