



## Mirella 4/ Appartement I2

### Studio

Entrée : 3.15 sq.m.  
Terrasse : 3.21 sq.m.  
Salon + cuisine : 26.16 sq.m.  
Salle de bain (1) : 4.48 sq.m.  
Entrée : 3.15 sq.m.  
Parties communes : 5.15 sq.m.  
Surface totale : 37.00 sq.m.  
Totale + Parties communes : 42.15 sq.m.

**Prix\* : 48 741.00 EUR**

*\* Vat inclure*

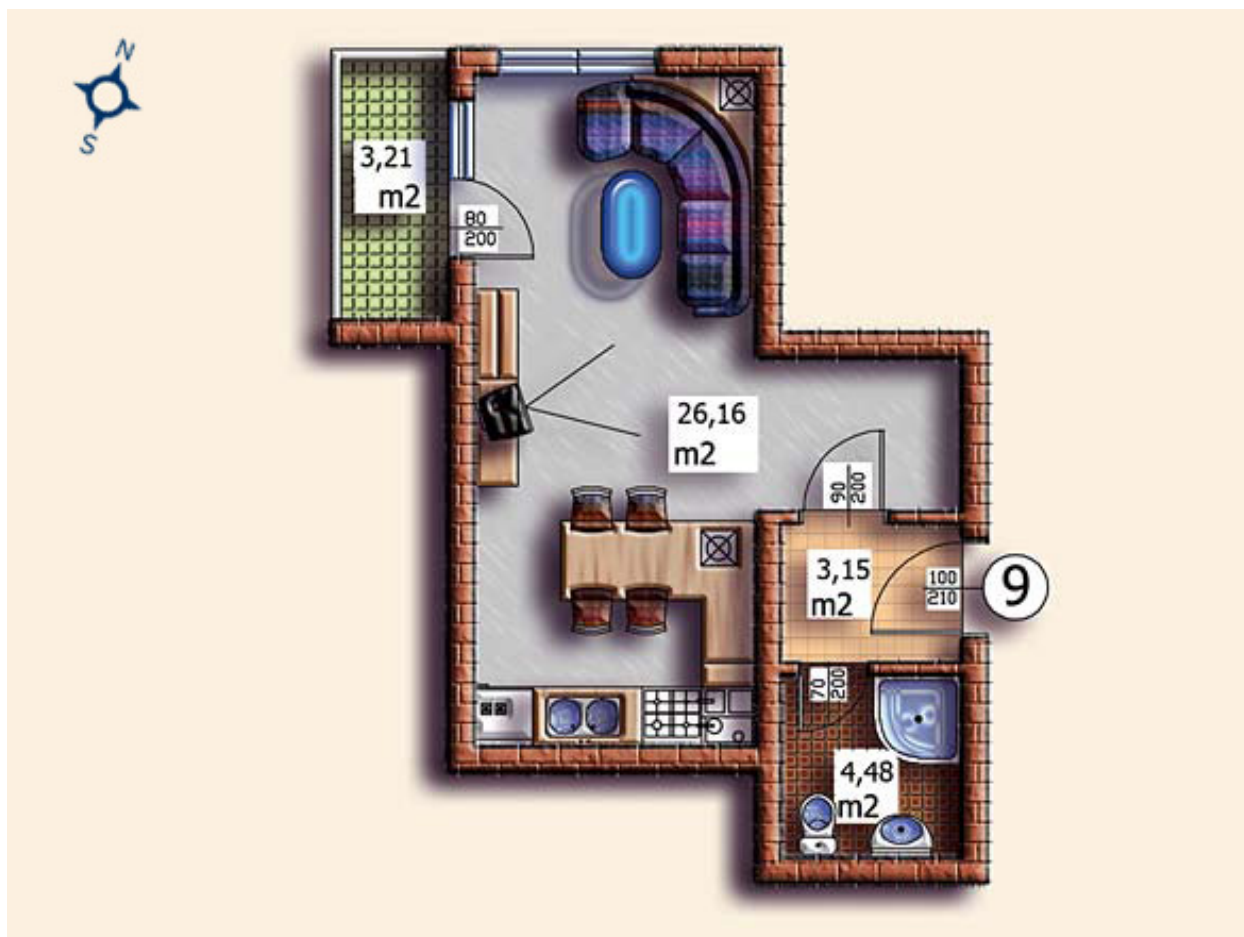



# Crystal Spa Aparthotel

partie de golden valley village

